

01 VISTA V1
ESC.: 1/25

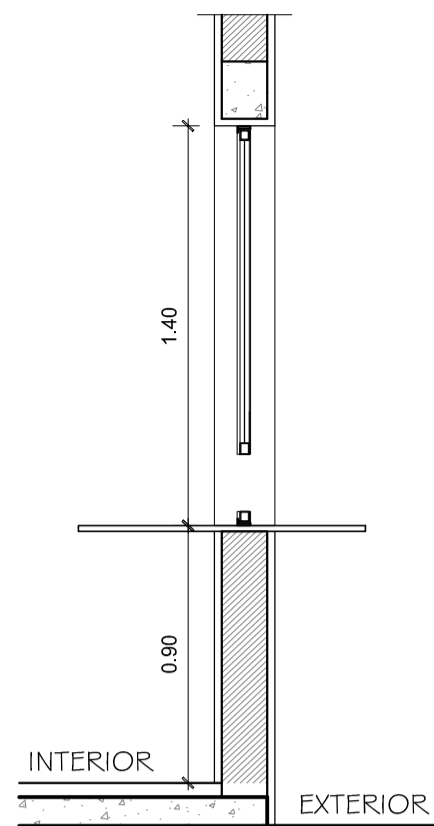

02 CORTE I
ESC.: 1/25

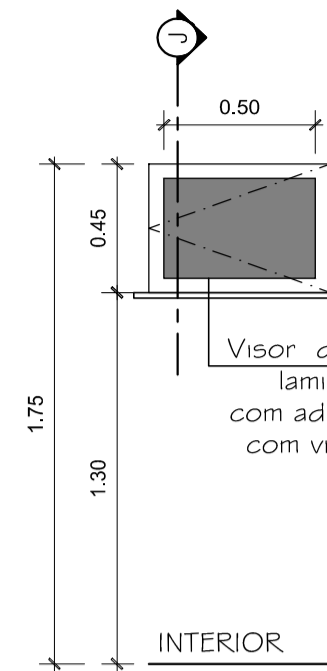

03 VISTA V2
ESC.: 1/25

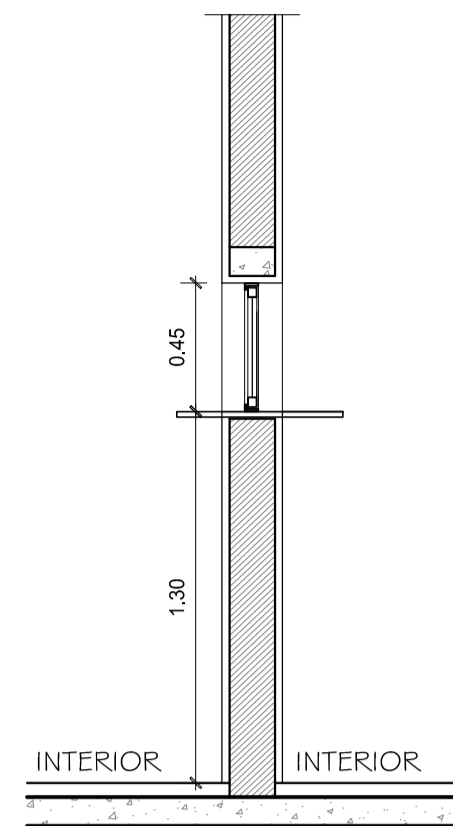

04 CORTE J
ESC.: 1/25

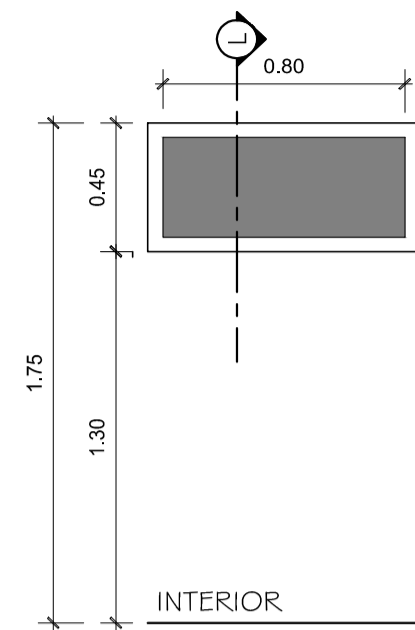

05 VISTA V3
ESC.: 1/25

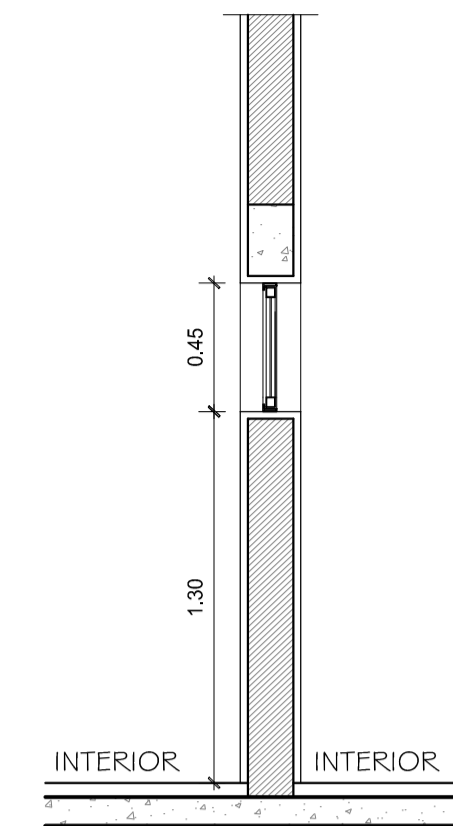

06 CORTE L
ESC.: 1/25

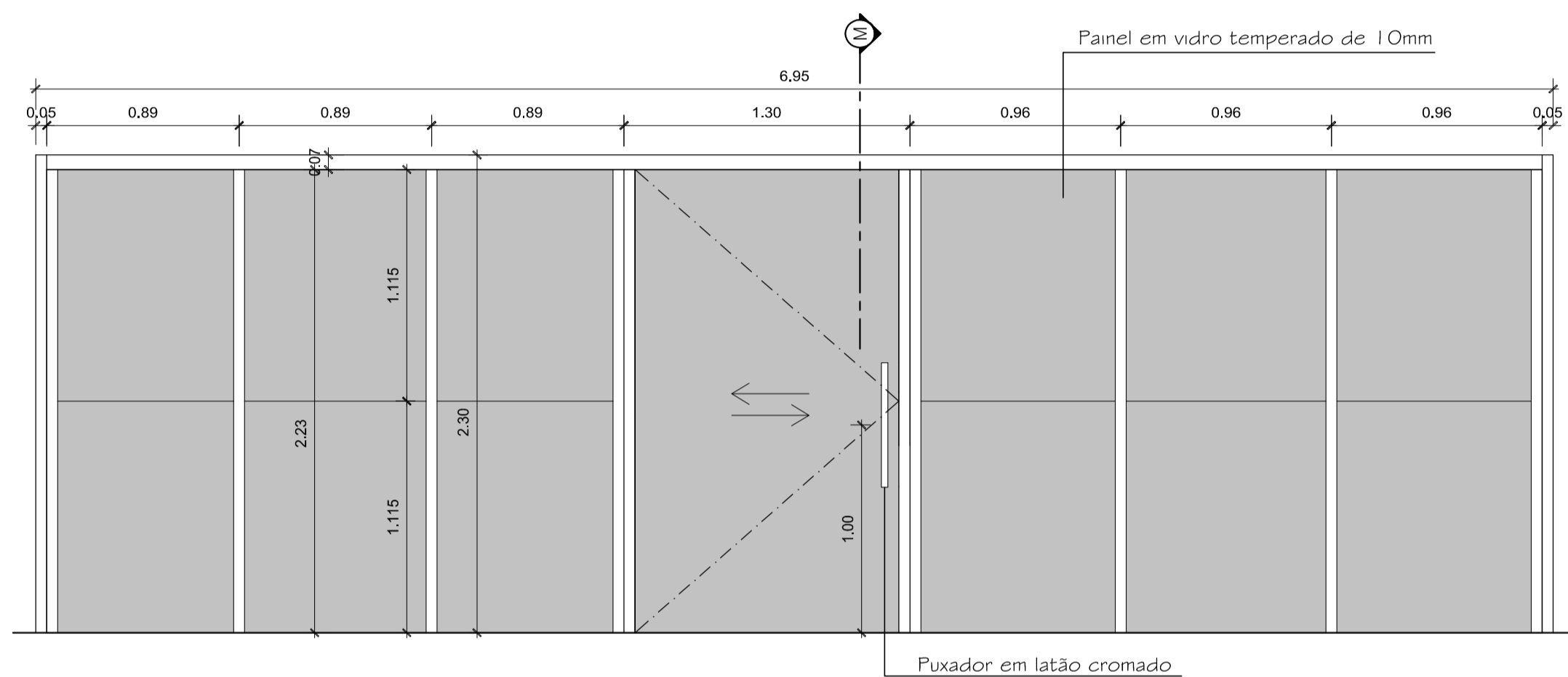

07 VISTA - PV1
ESC.: 1/25

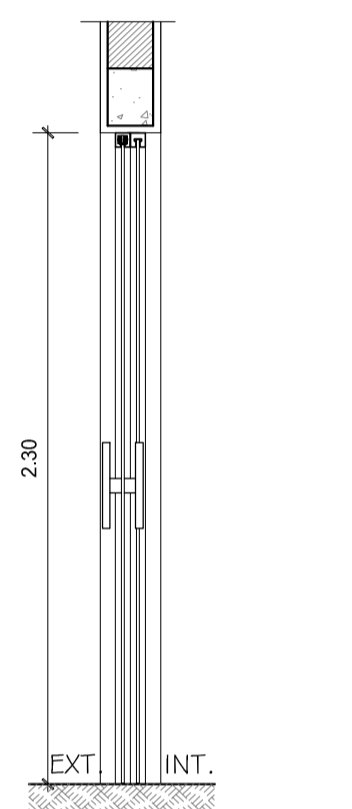

08 CORTE M
ESC.: 1/25

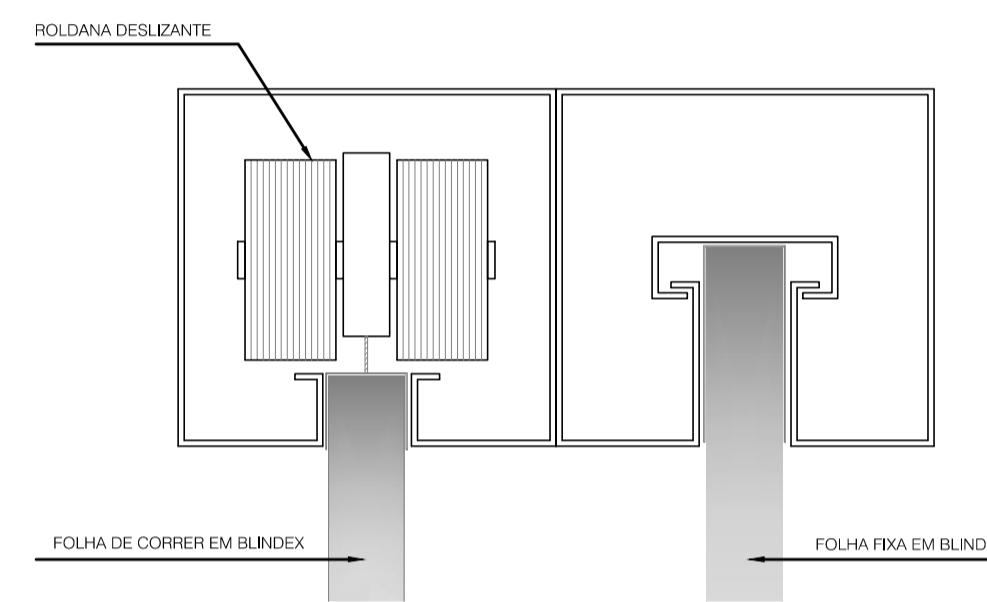

09 DETALHE ESQUEMÁTICO 02 - TRILHOS P6
ESC.: 1/1

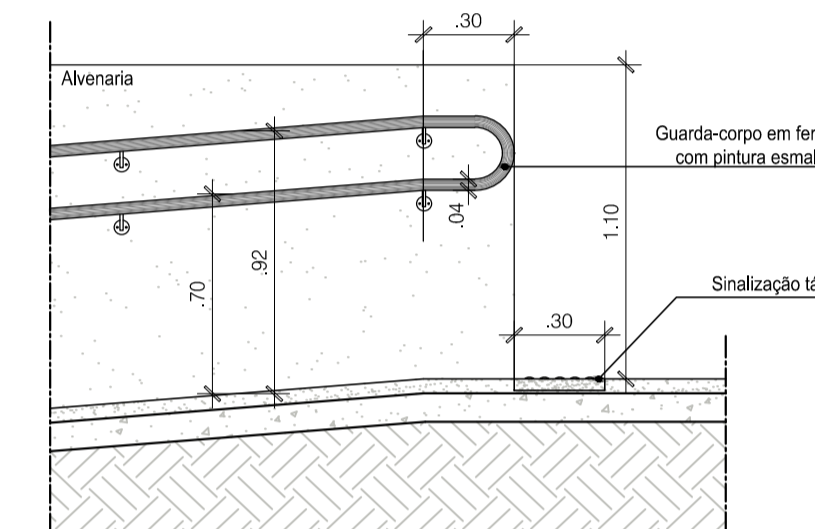

10 DET. PADRÃO RAMPA
ESC.: 1/25

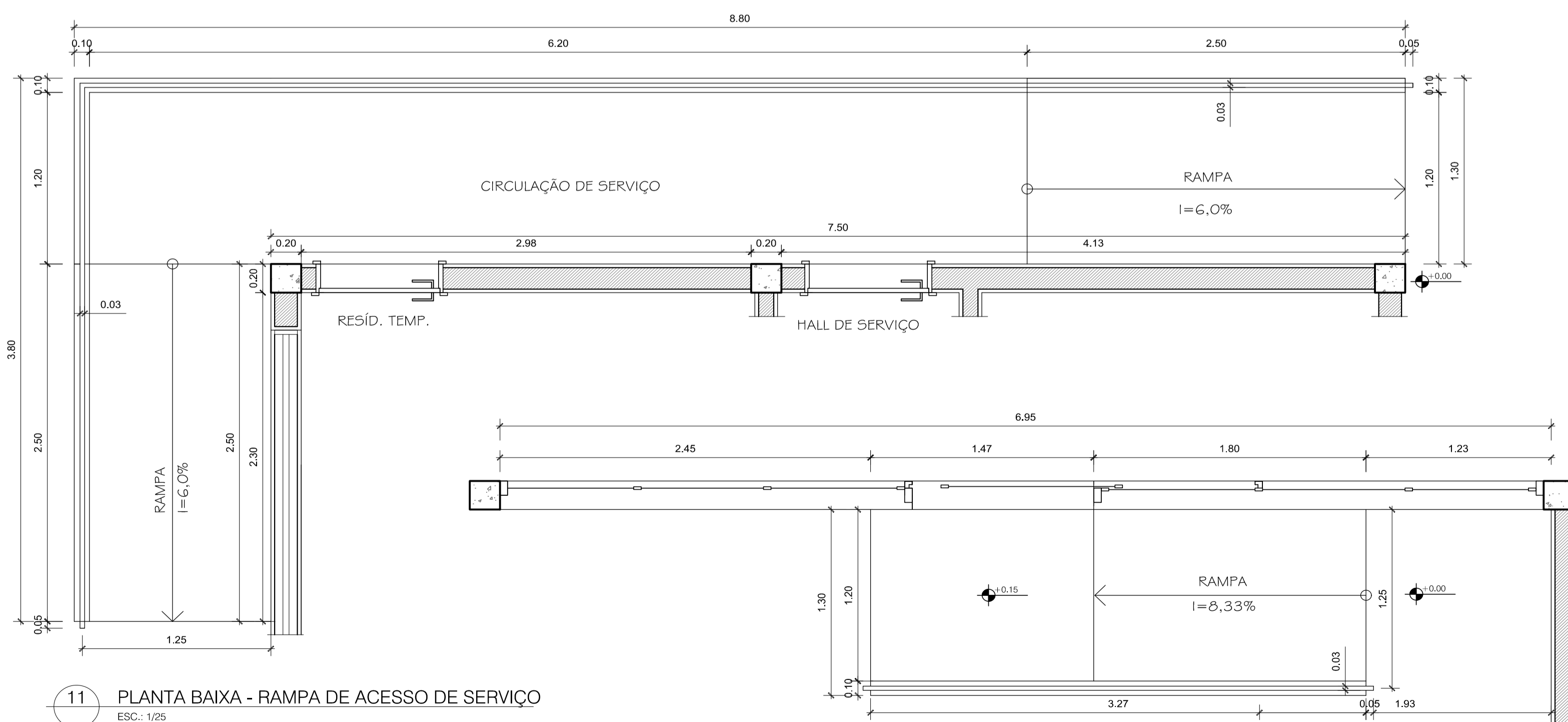

11 PLANTA BAIXA - RAMPA DE ACESSO DE SERVIÇO
ESC.: 1/25

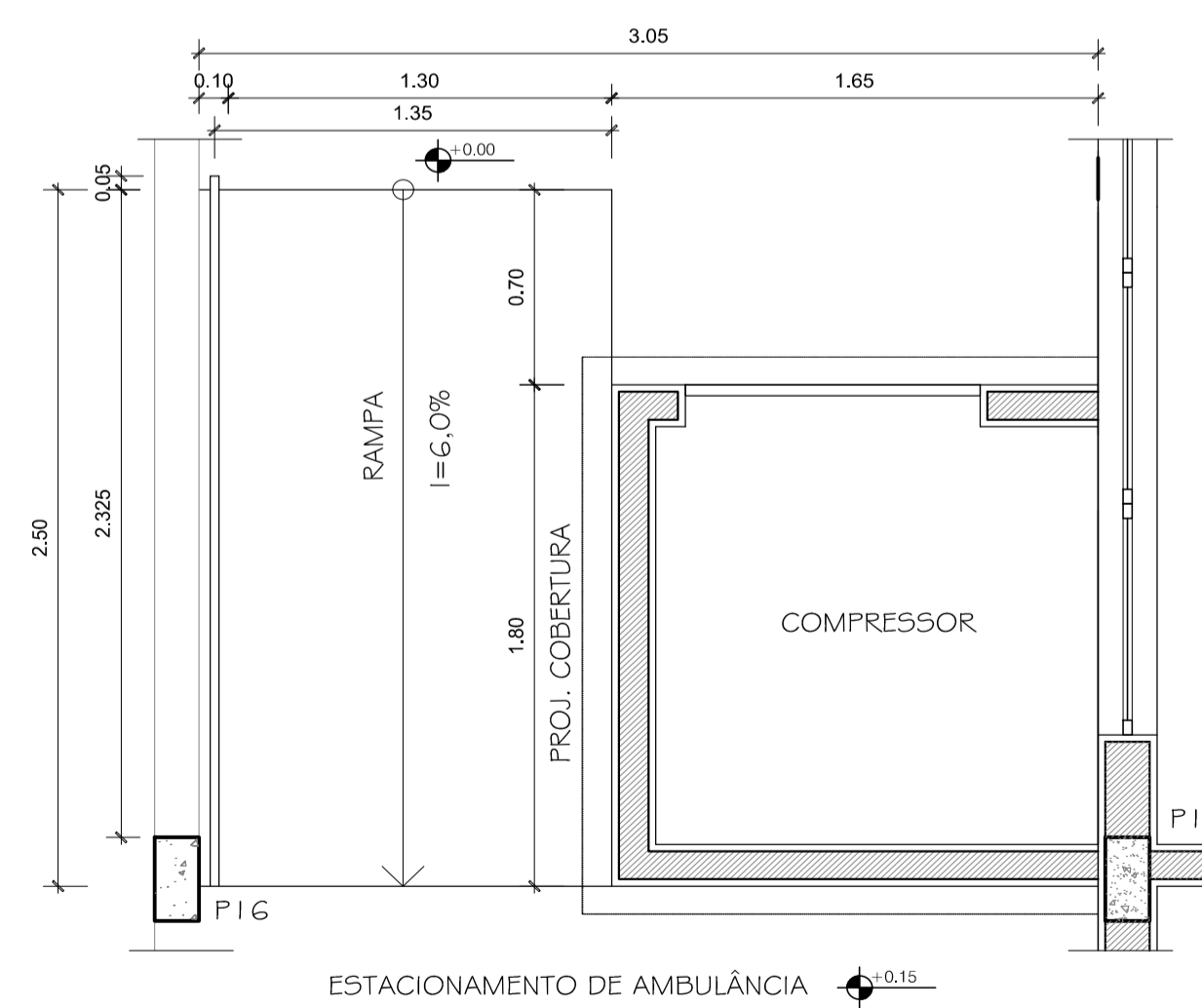

13 PLANTA BAIXA - RAMPA DE ACESSO DE SERVIÇO
ESC.: 1/25

12 PLANTA BAIXA - RAMPA DE ACESSO PRINCIPAL
ESC.: 1/25

OBS:
1. Cotas em metros.

REV.	EMISSÃO INICIAL	DATA	DES.	CONF.	APR.
00	EMISSÃO INICIAL	07/10/2014			

FRANCHA:
09
09

Projeto de Unidade Básica de Saúde - Sambaetiba
Detalhamento das Esquadrias

Rua da Ligaçao, RJ 116 km 07
Rodovia Nova Friburgo - Itaboraí

CONTRATO

PRPA: Mônica Stavale
DESENHO: Cristiane Aguiar
DATA: Nov/2014
ESCALA: 1/25

ms PROJETOS
Av. Nilo Peçanha, 50 - Grupo 2613 - Centro - Rio de Janeiro - RJ
Brasil - Cep: 20020-906 - e-mail: monicaprojetos@gmail.com.br
www.msprojetos.com.br

ITABORAÍ\UBS\UBS_SAMBAETIBA\HURIBIARIO_07.007_DET_ESQUADRIAS_F00.DWG